

Ecophon Fade™ Duo

Fade™ Duo offers a seamless acoustic solution with a fine surface that is easy and quick to install. The system consists of only three main components; Fade™ Acoustic board, Fade™ Duo Primer and Fade™ Duo Top.

Install the acoustic board mechanically with special metal fixings from the manufacturer or install the acoustic board with approved adhesive on the suitable substrate.
Thanks to its flexibility, possibility to colour and

seamless look, it is a solution for several applications from historic buildings to high-end residential, commercial, retail and educational spaces.



SYSTEM RANGE

	Size, mm	1200x1200	1200x1200	1200x1200
	Direct	•	•	•
	Direct to grid, mechanically	•	•	•
	Direct to suspended substrate, adhesive	•	•	•
	Direct to suspended substrate, mechanically	•	•	•
	Direct, adhesive	•	•	•
	Suspended	•	•	•
	Thickness (THK)	15	25	40
	Inst. Diag.	M621, M622 , M623 , M624, M625	M621, M622 , M623 , M624, M625	M621, M622 , M623 , M624, M625



Acoustic

Sound Absorption:

Test results according to EN ISO 354. Classification according to EN ISO 11654, and the single value rating for Noise Reduction Coefficient, NRC, according to ASTM C 423.

α_p , Practical sound absorption coefficient

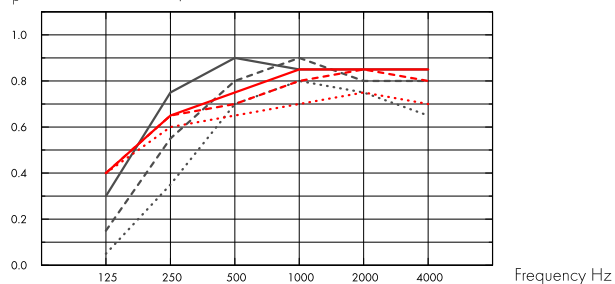

- Fade Duo, 15 mm, 20 mm o.d.s.
 - Fade Duo, 25 mm, 30 mm o.d.s.
 - Fade Duo, 40 mm, 45 mm o.d.s.
 - Fade Duo, 15 mm, 200 mm o.d.s.
 - Fade Duo, 25 mm, 200 mm o.d.s.
 - Fade Duo, 40 mm, 200 mm o.d.s.
- o.d.s = overall depth of system

THK mm	o.d.s. mm	α_p , Practical sound absorption coefficient						α_w	Sound absorption class
		125 Hz	250 Hz	500 Hz	1000 Hz	2000 Hz	4000 Hz		
15	20	0.05	0.35	0.70	0.80	0.75	0.65	0.65	C
25	30	0.15	0.55	0.80	0.90	0.80	0.80	0.80	B
40	45	0.30	0.75	0.90	0.85	0.85	0.85	0.90	A
15	200	0.40	0.60	0.65	0.70	0.75	0.70	0.70	C
25	200	0.40	0.65	0.70	0.80	0.85	0.80	0.80	B
40	200	0.40	0.65	0.75	0.85	0.85	0.85	0.85	B

	THK mm	o.d.s. mm	NRC
	15	20	0.65
	25	30	0.75
	40	45	0.85
	15	200	0.65
	25	200	0.75
	40	200	0.80



Indoor Air Quality

Certificate / Label	
French VOC	A+
Finnish M1	•



Cradle to Cradle Certified®



This product is Cradle to Cradle Certified® at Silver level (version 3.1).



Material Health

This product has received a C2C Certified Material Health Certificate™ at the Silver level (standard version 4.0). The C2C Certified Material Health Certificate™ is a verification of the health and safety of a product's composition using the Material Health requirements of the Cradle-to-Cradle Certified Product Standard.



Environmental Footprint

kg CO ₂ equiv/kg	
Fade Duo Primer	0,45
Fade Duo Top	0,40

Life-cycle stages A1 to A3 from EPD, in conformity with ISO 14025 / EN 15804+A1



Fire safety

Country	Class
Europe	EN 13501-1 A2-s1,d0

The glass wool core of the tiles is tested and classified as non-combustible according to EN ISO 1182. Fire test, E 84-11a.



Humidity Resistance

Resistance to Humidity (RH 100%, 40°C) - ISO DS/EN 6270-2



Visual appearance

White NCS S 0502-Y20R, CIE Y=80% light reflectance. Exposure to UV-light - ASTM G 154-16 . Gloss < 1 . Colours may vary slightly between different production batches.



Cleanability

Surface dust and dirt can be vacuumed off using a soft brush attachment.



Accessibility

The system supports installation of inspection hatch.



Installation

Installed according to installation diagrams, installation guides and drawing aid. For information regarding minimum overall depth of system see quantity specification. When installing direct-to-grid the installer must ensure that the building is airtight to prevent dust deposits from airflow through the open-pored acoustic plaster system.



System weight

The weight of the system (including suspension grid) should be approximately M621/M622 ≈ 3 - 7 kg/m², M623 ≈ 5 - 8 kg/m², M624/M625 ≈ 13 - 18 kg/m².



Mechanical properties

Additional load (lighting, ventilation, etc.) should be supported by the suspension system according to the manufacturers recommendation or be hung directly from the soffit.



CE

Ecophon ceiling systems are CE marked according to the European harmonized standard EN13964:2014. CE marked construction products are covered by a Declaration of Performance (DOP) which enables customers and users to easily compare performance of products available on the European market.

INSTALLATION DIAGRAM (M621) FOR ECOPHON FADE™ DUO DIRECT FIXATION, MECHANICAL

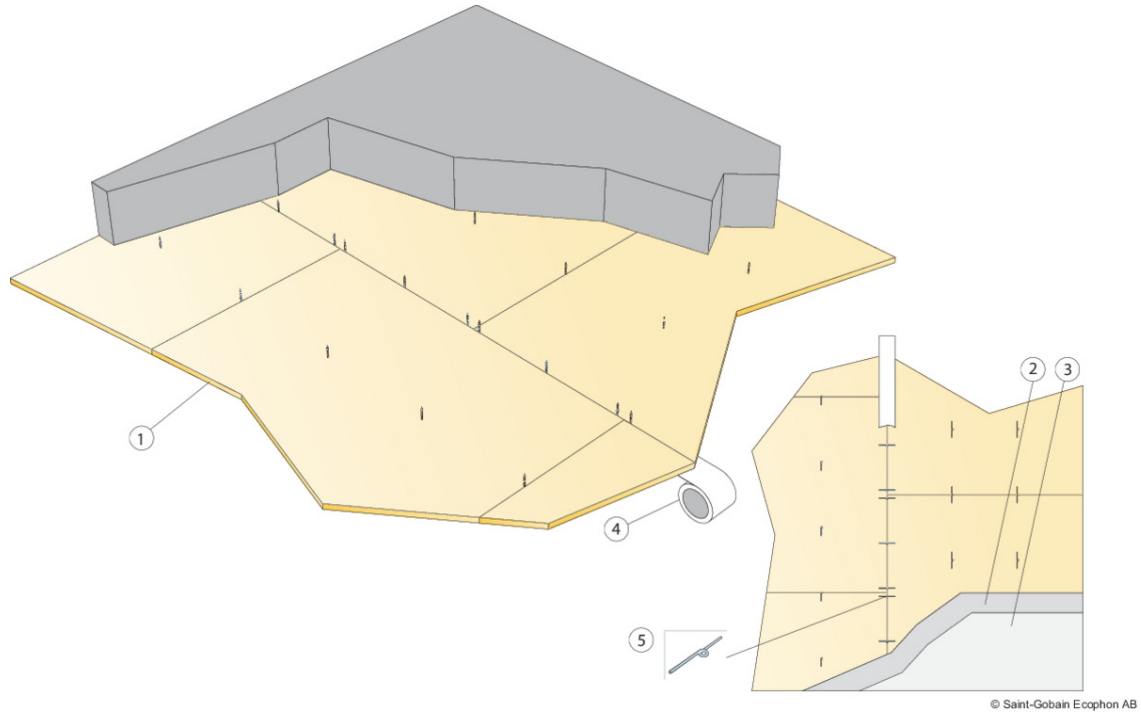

QUANTITY SPECIFICATION (EXCL. WASTAGE)

		Size, mm
		1200x1200
1	Acoustic board for Fade	0,7/m ²
2	Fade Duo Primer	1kg/m ²
3	Fade Duo Top	0,3kg/m ²
4	EU Fade Special joint tape (every seem on tiles)	1,7m/m ²
5	Fade Special washer (fixed with applicable screw)	8pcs/m ²
Δ Min. overall depth of system: 18 - 43 mm		-
δ Min. demounting depth: The system is not demountable		-

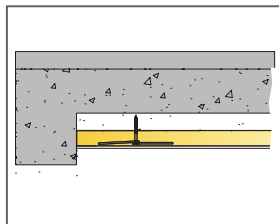

Size, mm	Max live load (N)	Min load bearing capacity (N)
1200x1200x15	0	0
1200x1200x25	0	0
1200x1200x40	0	0

Live load/load bearing capacity

INSTALLATION DIAGRAM (M622) FOR ECOPHON FADE™ DUO DIRECT FIXATION WITH GLUE

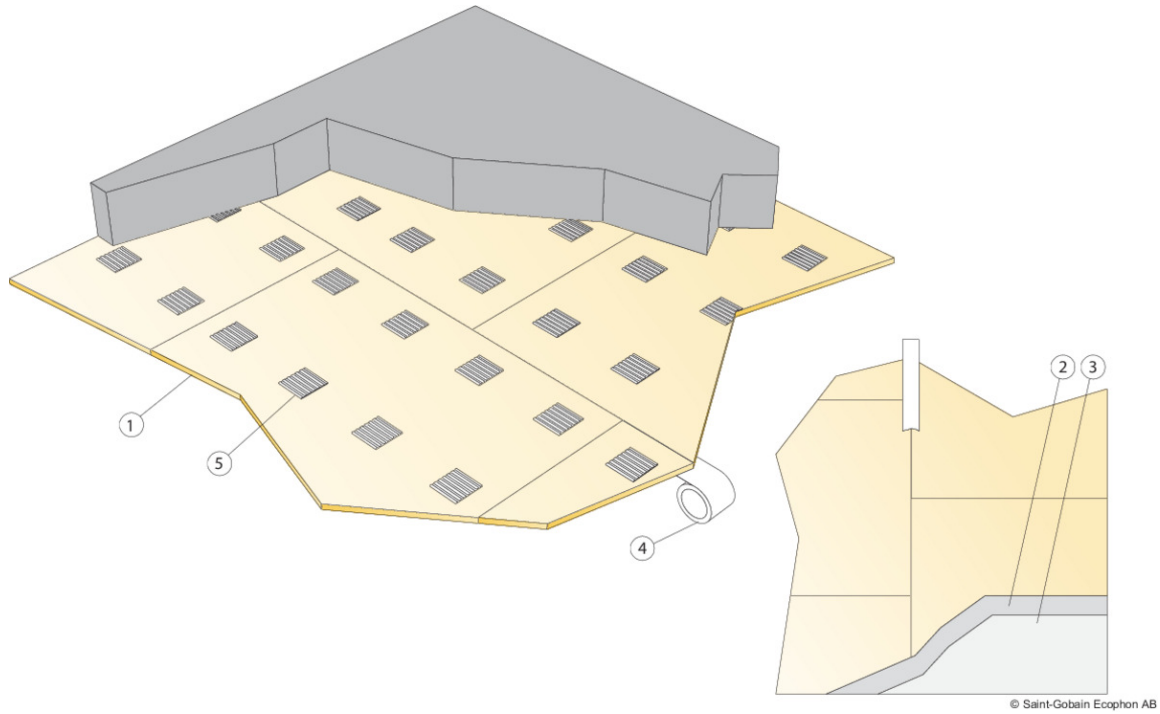

QUANTITY SPECIFICATION (EXCL. WASTAGE)

		Size, mm
		1200x1200
1	Acoustic board for Fade	0,7/m ²
2	Fade Duo Primer	1kg/m ²
3	Fade Duo Top	0,3kg/m ²
4	EU Fade Special joint tape (every seem on tiles)	1,7m/m ²
5	Fade Special Adhesive 10kg	0,83kg/m ²
Δ Min. overall depth of system: 18 - 43 mm		-
δ Min. demounting depth: The system is not demountable		-

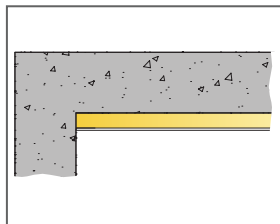

Size, mm	Max live load (N)	Min load bearing capacity (N)
1200x1200x15	0	0
1200x1200x25	0	0
1200x1200x40	0	0

Live load/load bearing capacity

INSTALLATION DIAGRAM (M623) FOR ECOPHON FADE™ DUO SUSPENDED GRID, MECHANICAL FIXATION

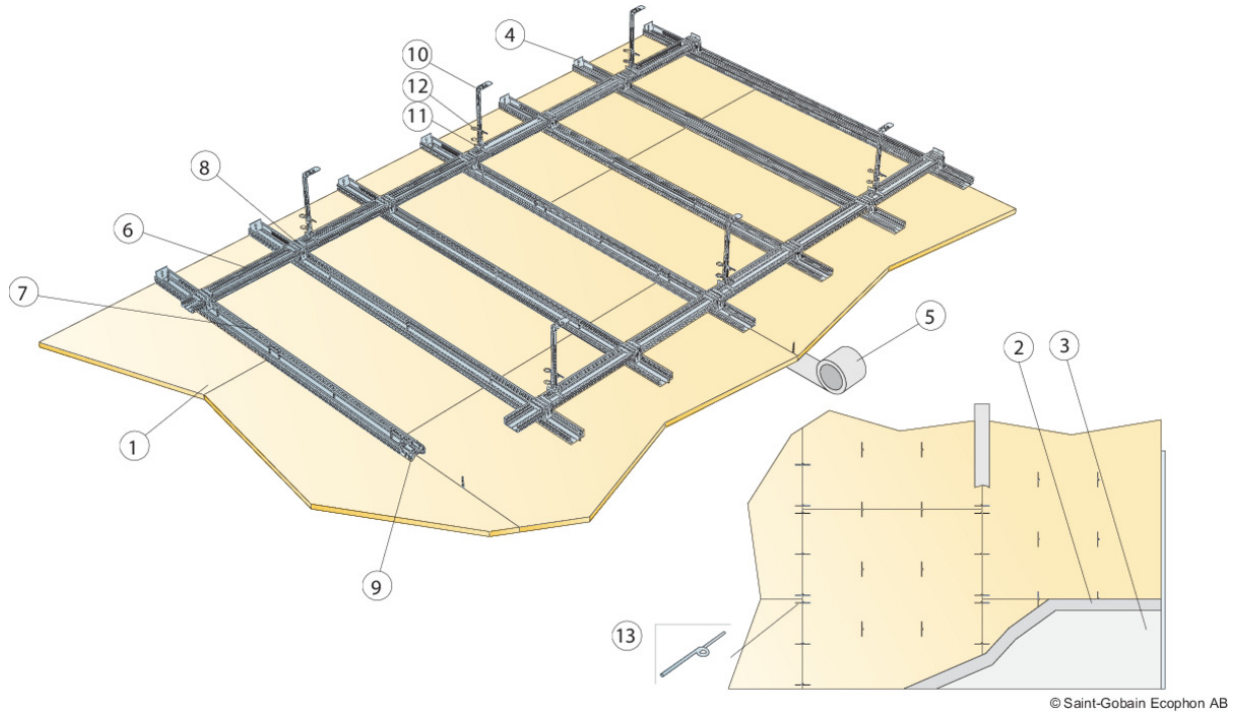

QUANTITY SPECIFICATION (EXCL. WASTAGE)

		Size, mm
		1200x1200
1	Acoustic board for Fade	0,7/m ²
2	Fade Duo Primer	1kg/m ²
3	Fade Duo Top	0,3kg/m ²
4	Connect Wall bracket Plus	as required
5	EU Fade Special joint tape (every seem on tiles)	1,7m/m ²
6	Connect C-profile Plus, L=3100 mm, installed 1200 mm centres	0,9m/m ²
7	Connect C-profile Plus, L=3100 mm, installed 400 mm centres	2,5m/m ²
8	Connect X-connector Plus	3,2/m ²
9	Connect Splice connector Plus	1,2/m ²
10	Connect Nonius hanger upper, installed at 800 mm centres	1,6/m ²
11	Connect Nonius hanger lower, installed at 800 mm centres	1,6/m ²
12	Connect Split pin (2/hanger)	3,2/m ²
13	Fade Special washer (fixed with applicable screw)	8pcs/m ²
Δ Min. overall depth of system: 310 mm		-
δ Min. demounting depth: The system is not demountable		-

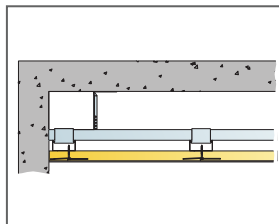

Size, mm	Max live load (N)	Min load bearing capacity (N)
1200x1200x15	50	160
1200x1200x25	50	160
1200x1200x40	50	160

Live load/load bearing capacity

INSTALLATION DIAGRAM (M624) FOR ECOPHON FADE™ DUO SUSPENDED GRID, MECHANICAL FIXATION TO SUBSTRATE

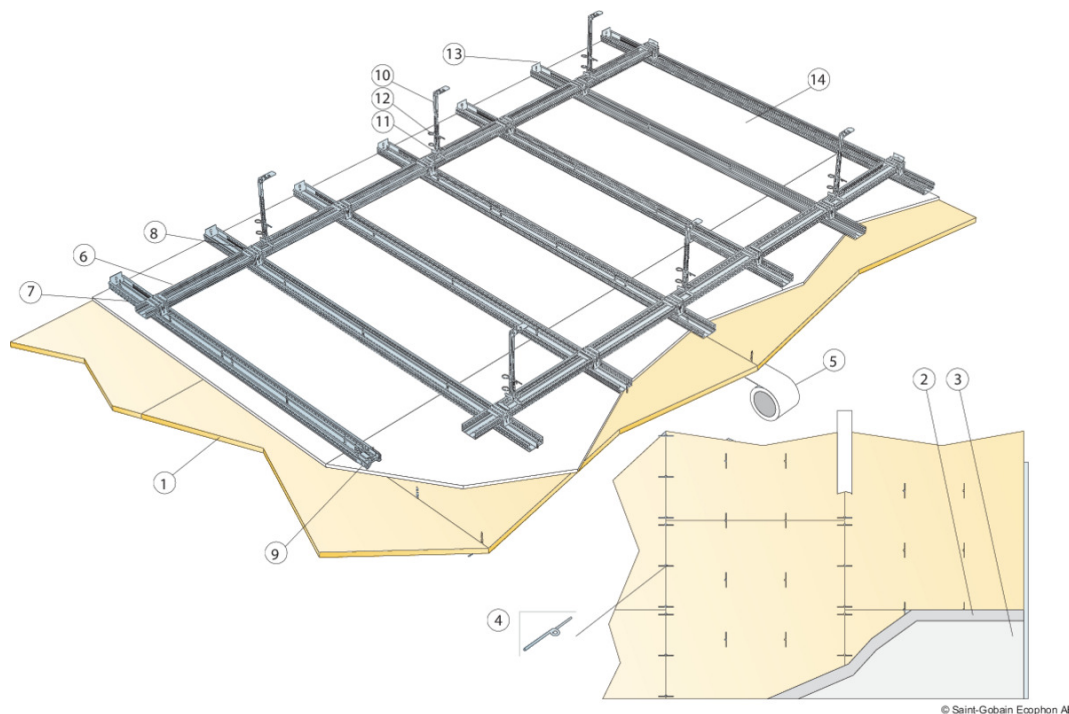

QUANTITY SPECIFICATION (EXCL. WASTAGE)

		Size, mm
		1200x1200
1	Acoustic board for Fade	0,7/m ²
2	Fade Duo Primer	1 kg/m ²
3	Fade Duo Top	0,3kg/m ²
4	Fade Special washer (fixed with applicable screw)	8pcs/m ²
5	EU Fade Special joint tape (every seem on tiles)	1,7m/m ²
6	Connect C-profile Plus, L=3100 mm, installed 1200 mm centres	0,9m/m ²
7	Connect C-profile Plus, L=3100 mm, installed 400 mm centres	2,5m/m ²
8	Connect X-connector Plus	3,2/m ²
9	Connect Splice connector Plus	1,2/m ²
10	Connect Nonius hanger upper, installed at 800 mm centres	1,6/m ²
11	Connect Nonius hanger lower, installed at 800 mm centres	1,6/m ²
12	Connect Split pin (2/hanger)	3,2/m ²
13	Connect Wall bracket Plus	as required
14	Plasterboard (not supplied by Ecophon)	-
Δ Min. overall depth of system: 310 mm		-
δ Min. demounting depth: The system is not demountable		-

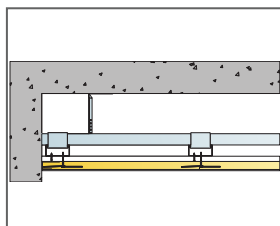

Size, mm	Max live load (N)	Min load bearing capacity (N)
1200x1200x15	40	220
1200x1200x25	40	220
1200x1200x40	40	220

Live load/load bearing capacity

INSTALLATION DIAGRAM (M625) FOR ECOPHON FADE™ DUO SUSPENDED GRID, GLUED TO SUBSTRATE

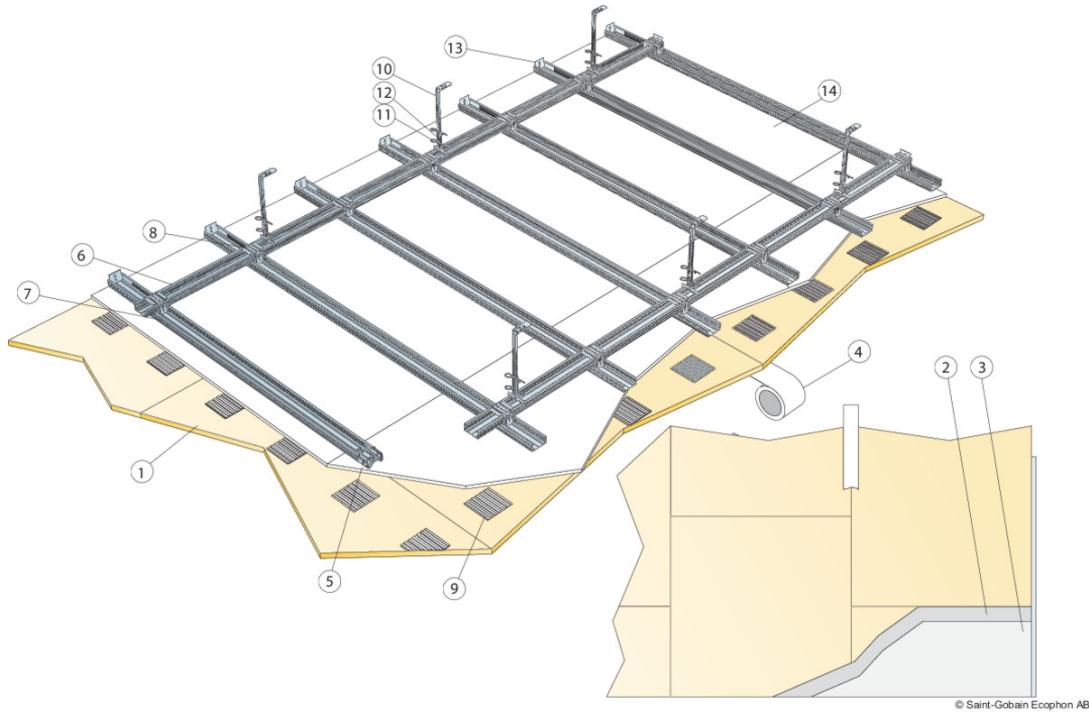

QUANTITY SPECIFICATION (EXCL. WASTAGE)

		Size, mm
		1200x1200
1	Acoustic board for Fade	0,7/m ²
2	Fade Duo Primer	1kg/m ²
3	Fade Duo Top	0,3kg/m ²
4	EU Fade Special joint tape (every seem on tiles)	1,7m/m ²
5	Connect Splice connector Plus	1,2/m ²
6	Connect C-profile Plus, L=3100 mm, installed 1200 mm centres	0,9m/m ²
7	Connect C-profile Plus, L=3100 mm, installed 400 mm centres	2,5m/m ²
8	Connect X-connector Plus	3,2/m ²
9	Fade Special Adhesive 10kg	0,83kg/m ²
10	Connect Nonius hanger upper, installed at 800 mm centres	1,6/m ²
11	Connect Nonius hanger lower, installed at 800 mm centres	1,6/m ²
12	Connect Split pin (2/hanger)	3,2/m ²
13	Connect Wall bracket Plus	as required
14	Plasterboard (not supplied by Ecophon)	-
Δ Min. overall depth of system: 310 mm		-
δ Min. demounting depth: The system is not demountable		-

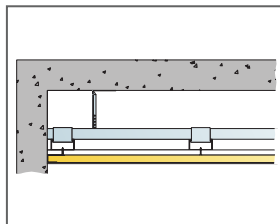

Size, mm	Max live load (N)	Min load bearing capacity (N)
1200x1200x15	40	220
1200x1200x25	40	220
1200x1200x40	40	220

Live load/load bearing capacity